



Bromley Cross Road

Bolton, BL7 9LS

£245,000



This bright and airy 3-bedroom semi-detached dormer bungalow is sat in the very heart of Bromley Cross on a generous plot, featuring a large drive, storage outbuilding, and spacious gardens to the front, side and rear. Two of your three bedrooms benefit from en-suites, while the main bathroom is adjacent to your master bedroom; meaning each bedroom essentially has its own bathroom! It's evident to see this house has been loved. This property will make a great home for a young couple or family, as well as those looking to downsize while having a good amount of space inside and out, not to mention the highly convenient and desirable location.

Whether it's the generous plot, highly convenient location, or bright and airy, well-presented interiors that appeal to you, this property has plentiful benefits! Let's take a closer look...



Step Inside

Pop your shoes off in the entrance vestibule and hang your coat in the handy storage closet by the door, and be welcomed into your spacious open plan living area...

A bay window to the front and double glass doors to the rear allow natural light to pour into this space, creating a bright and airy feel. Your spacious open living area is arranged such that your sitting room lies at the front, featuring a gas fire, and your dining area sits to the rear overlooking the back garden.

Your kitchen is situated off the open plan living area; featuring wooden cupboards with a contrasting dark grey worktop, a stainless steel double oven and gas hob with complementary splashback and extractor, and an integral fridge-freezer.

Beds & Baths

Your master bedroom can be found on the ground floor - this room is generous in size and benefits from lots of natural light from the large window onto the back garden, with more laminate wood flooring and a neutral colour scheme. The main bathroom sits next to your master bedroom and features white tiled walls and three-piece suite, including bath with shower, wash basin and loo. Upstairs are your two other bedrooms where the bright and airy feel continues. Both benefit from en-suites, each featuring a shower cubicle, wash basin and loo, which are set amongst more white tiled walls with dark grey tiled flooring.

Outside Spaces

One of the great advantages about this property is its enviable plot that provides a great amount of outside space to do with what you please...

The large drive at the front is big enough for multiple cars, and the storage outbuilding in the back garden provides a good place for all your outdoor bits and bobs.

As well as serving the practical side of life your outside space provides a lovely recreational space too with plenty of privacy! Indoor-outdoor living in the summer months would be a dream at this property, with the glass doors opening onto the decking and lawn area in the back garden - perfect for lounging in the sun! With the back garden being south facing you'll get the sun all day long.

In the Heart of Bromley Cross

In the very heart of Bromley Cross, perched in the middle of one of the most convenient streets in the area, this welcoming family home is in walking distance to everything you might need.

The village amenities of Bromley Cross are just a stone's throw up the road, providing a handy selection of shops, mini-supermarkets and cafes. For the kids, Turton High School is directly across the street. For commuting throughout the North West and beyond, Bromley Cross Train Station is just at the end of the road! And for scenic walks, Jumbles Country Park is right at the end of the road too...

With a real village-like feel and everything on your doorstep, it doesn't get much more convenient than this!

Services & Specifics

We are advised:

The property is Leasehold with a ground rent of £4 per annum.

The Leasehold term is 900+ years (999 years from 1959).

The tax band is C.

The property is heated via gas central heating with a combi boiler.

The utilities are connected to mains supply.

Area Map

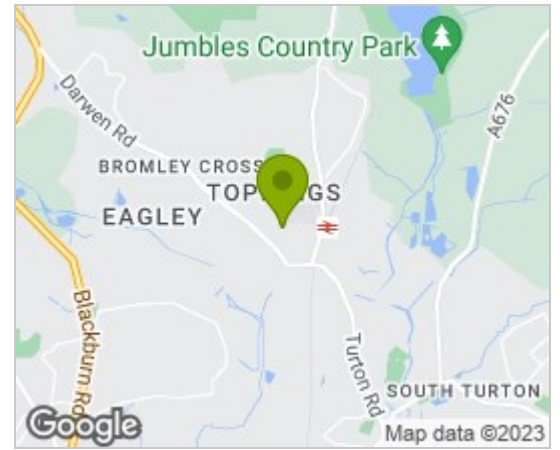

Floor Plans

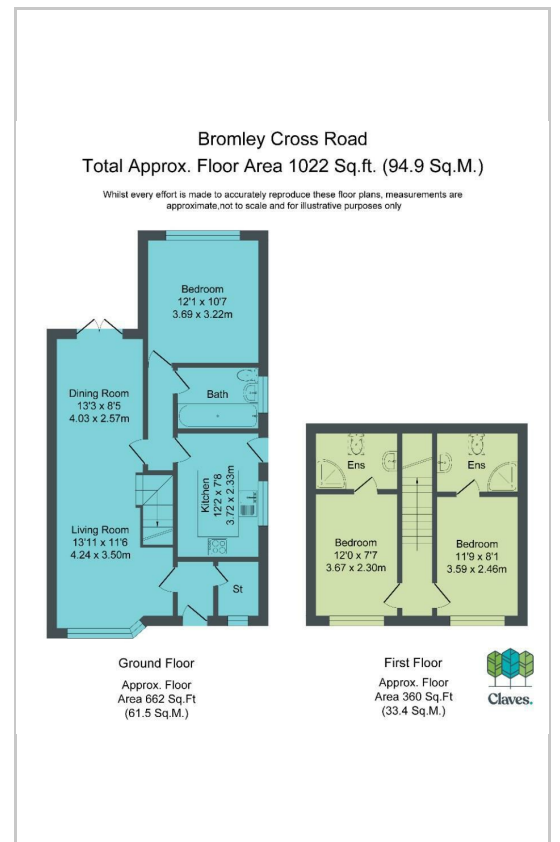

Energy Efficiency Graph

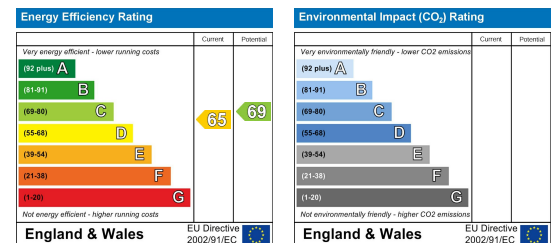

These particulars, whilst believed to be accurate are set out as a general outline only for guidance and do not constitute any part of an offer or contract. Intending purchasers should not rely on them as statements of representation of fact, but must satisfy themselves by inspection or otherwise as to their accuracy. No person in this firm's employment has the authority to make or give any representation or warranty in respect of the property.



Claves House, 295D Darwen Road, Bromley Cross, BL7 9BT.
t. 01204 929 940 | e. info@claves.co.uk | w. claves.co.uk